

00-094Z

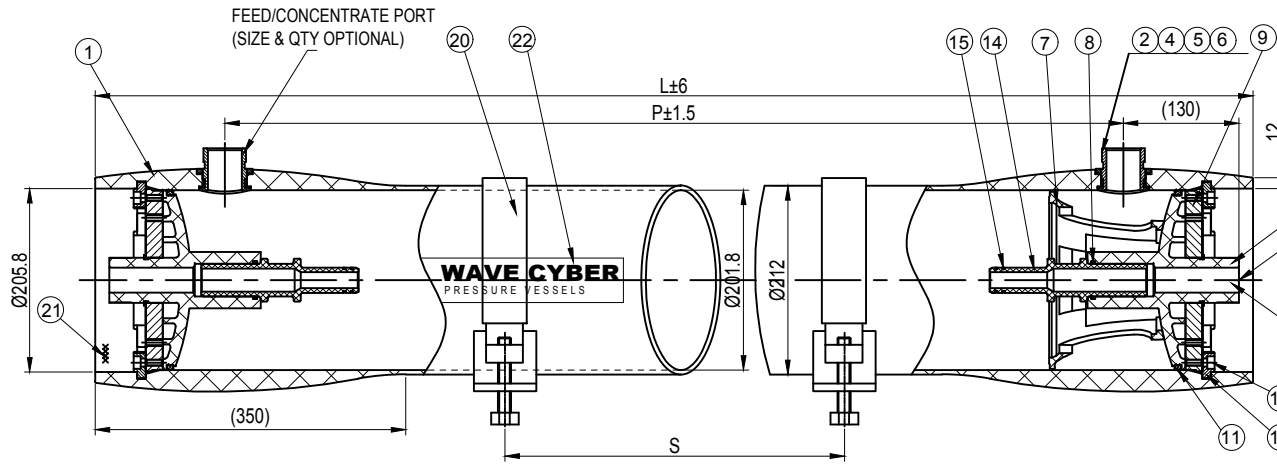

WARNING!
 PRESSURE IN THE PERMEATE PORT SHALL NOT EXCEED 125 PSI (0.86MPa)

PERMEATE PORT
 OPTION F----NPT 1" FEMALE THREAD;
 OPTION G----Rp 1" FEMALE THREAD;
 OPTION H---- UNION ADAPTOR;
 FIT 32mm(O.D) PIPE
 OPTION J----UNION ADAPTOR;
 FIT 1.32"(O.D) PIPE
 OPTION V----Mechanical Coupling 1"-ABS;
 OPTION S----Mechanical Coupling 1"-SS;

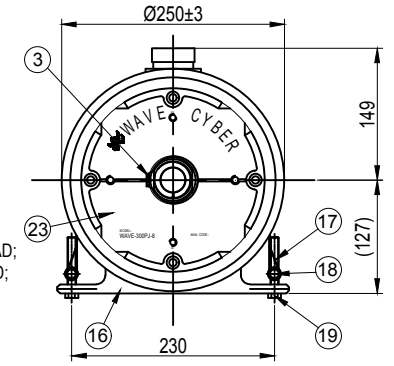

NUT SHIM	27300-06-03	2.5"	20998	
	27300-06-02	2"	20997	
	27300-06-01	1.5"	20978	
SIDE PORT NUT	27300-05-03	2.5"	20996	
	27300-05-02	2"	20995	
	27300-05-01	1.5"	20977	
SIDE PORT SEAL	27300-04-03	2.5"	11591	
	27300-04-02	2"	11590	
	27300-04-01	1.5"	11571	
SIDE PORT	27300-02-03	2.5"	20992	
	27300-02-02	2"	20991	
	27300-02-01	1.5"	20975	
SHELL	27450-01-03	2.5"		
	27450-01-02	2"		
	27450-01-01	1.5"		
DESCRIPTION	DRAWING NO.	CODE	SIZE	COMPUTER CODE

1.Flexible piping should be used on permeate connection to manifold.
 2.Side port misalignment can not exceed 0.7mm in any direction.
 3.MPV is not designed for negative pressures.

SHELL Length Code	L Inch (mm)	P Standard Inch (mm)	S Span Inch (mm)	Shell Weight lb (kg)
-1	58.4 (1485)	47 (1194)	1@28 (711)	52.8 (24)
-1.5	78.4 (1993)	67 (1702)	1@42 (1067)	61.6 (28)
-2	98.4 (2501)	87 (2210)	1@56 (1422)	69.3 (31.5)
-3	138.4 (3517)	127 (3226)	1@80 (2032)	85.8 (39)
-4	178.4 (4533)	167 (4242)	2@64 (1626)	102.3 (46.5)
-5	218.4 (5549)	207 (5258)	2@78 (1981)	118.8 (54)
-6	258.4 (6565)	247 (6274)	2@92 (2337)	135.3 (61.5)
-7	298.4 (7581)	287 (7290)	2@106 (2692)	151.8 (69)
-7.5	318.4 (8089)	307 (7798)	2@114 (2896)	160.6 (73)
-8	338.4 (8597)	327 (8306)	2@120 (3048)	168.3 (76.5)

PERMEATE PORT	DESCRIPTION	DRAWING NO.	CODE	PERMEATE PORT SPECS	COMPUTER CODE
		23300-10-08	UF	CONNECTED WITH VICTAULIC	10430
		23300-10-09	N	NPT 1 1/2" MALE THREAD	10844
		23300-10-06	M	NPT 1 1/4" MALE THREAD	10085
		23300-10-05	S	MECHANICAL COUPLING 1"-SS	10070
		23300-10-05	V	MECHANICAL COUPLING 1"-ABS	10070
		23300-10-05	J	UNION ADAPTOR(American Standard)	10070
		23300-10-05	F	NPT 1" FEMALE THREAD	10070
		23300-10-05	G	Rp 1" FEMALE THREAD	10070
		23300-10-05	H	UNION ADAPTOR(National Standard)	10070

ITEM	DESCRIPTION	DRAWING NO.	QTY	MATERIAL	COMPUTER CODE
23	ALUMINUM PLATE LABEL		2	ADHESIVE LABEL	41499
22	LOGO LABEL		2	ADHESIVE LABEL	40255
21	SERIAL NO. LABEL		1	ARTPAPER 20"53	40425
20	STRAP PROTECTIVE JACKET	23300-19	2or3	SOFT PVC	10188
19	STRAP SCREW		4or8	M8*90 STAINLESS STEEL	20129
18	STRAP NUT	23300-18	4or8	H0559-1	20123
17	STRAP	23300-17	2or3	304	20123
16	SADDLE	23300-16	2or3	LDPE	10141-1
15	ADAPTOR O RING	23300-14	4	EPDM	10182
14	ADAPTOR(Ø29.1)	23300-13	2	ABS	10125
13	BLOCK SCREW		8	M8*20 STAINLESS STEEL	20127
12	RETAINING BLOCK	23300-08	8	CAST ALUMINIUM	20380
11	HEAD SEAL	23300-26	2	EPDM	10175
10	PERMEATE PORT	SEE "PERMEATE PORT CONFIGURATIONS"	2	PP	SEE THE CHART
9	BEARING PLATE	23300-09	2	CAST ALUMINIUM	20979
8	PERMEATE PORT O RING	23300-08	2	EPDM	10181
7	THRUST CONE	23300-07	1	PP	10192
6	SIDE PORT NUT SHIM	SEE "SIDE PORT CONFIGURATIONS"	2	304	SEE THE CHART
5	SIDE PORT NUT	SEE "SIDE PORT CONFIGURATIONS"	2	304	SEE THE CHART
4	SIDE PORT SEAL	SEE "SIDE PORT CONFIGURATIONS"	2	SILICONE RUBBER	SEE THE CHART
3	PERMEATE RETAINING RING	23300-03	2	316	20107
2	SIDE PORT	SEE "SIDE PORT CONFIGURATIONS"	2	316	SEE THE CHART
1	SHELL	SEE "SIDE PORT CONFIGURATIONS"	1	FIBER GLASS + EPOXY	

TECHNICAL REQUIREMENT
 1.DESIGN PRESSURE 450PSI(3.1Mpa) ;
 2.DESIGN TEMPERATURE 150°F(65°C) ;
 3. MIN ALLOWABLE TEMPERATURE 20°F(-7°C) ;
 4.WORKING MEDIUM,WATER pH RANGE 3~10;
 5.PLEASE OPERATE IN ACCORDANCE WITH USER MANUAL;
 6.SPARE PARTS FORM JUST FOR REFERENCE,
 SPECIFIC FORM OF THE SPARE PART DRAWING PREVAIL.

REVISION	DESCRIPTION	SIGNATURE	DATE
	REFERENTIAL PLASTIC SHRINKAGE (IF NECESSARY):		
SIGNATURE		WAVE CYBER (SHANGHAI) CO., LTD.	
DESIGN	SCALE	MATERIAL	MODEL WAVE-450P-J-8
INSPECTION	1:6		DESCRIPTION
APPROVAL	QUANTITY	SMOOTHNESS	450P-J-8 MEMBRANE HOUSING
THIS PRODUCT DRAWING CAN NOT BE COPIED AND/OR USED WITHOUT PRIOR WRITTEN APPROVAL OF WAVE CYBER.		PROJECTION	DRAWING NO. 27450-00
		UNIT: MM	VERSION NO. 1
DO NOT MEASURE THE DIMENSIONS.		TOTAL PAGE: 1	